

Progressive Web App

COBI.time can now be installed and used just like an app.

This offers the convenience of a native application without the need for a web UI.

What is a PWA?

A Progressive Web App (PWA) is a web application that starts via its own app icon and runs in its own window (without a browser bar).

The Benefits:

- **Quick access** directly via the Desktop or Start Menu
- **App-like usage** (focused window)
- **Ideal for terminals** and shared devices
- **Automatic updates** - the app always stays up to date

Installation (Windows)

Installation is generally recommended for **Google Chrome** or **Microsoft Edge**, as these browsers support the feature natively.

Instructions for Chrome & Edge:

1. Open COBI.time in your browser: <https://time.....cloud/>
2. Click on the **“Install”** icon on the right side of the address bar (often a monitor symbol with an arrow).
3. Confirm the installation in the dialog window.

Google Chrome:

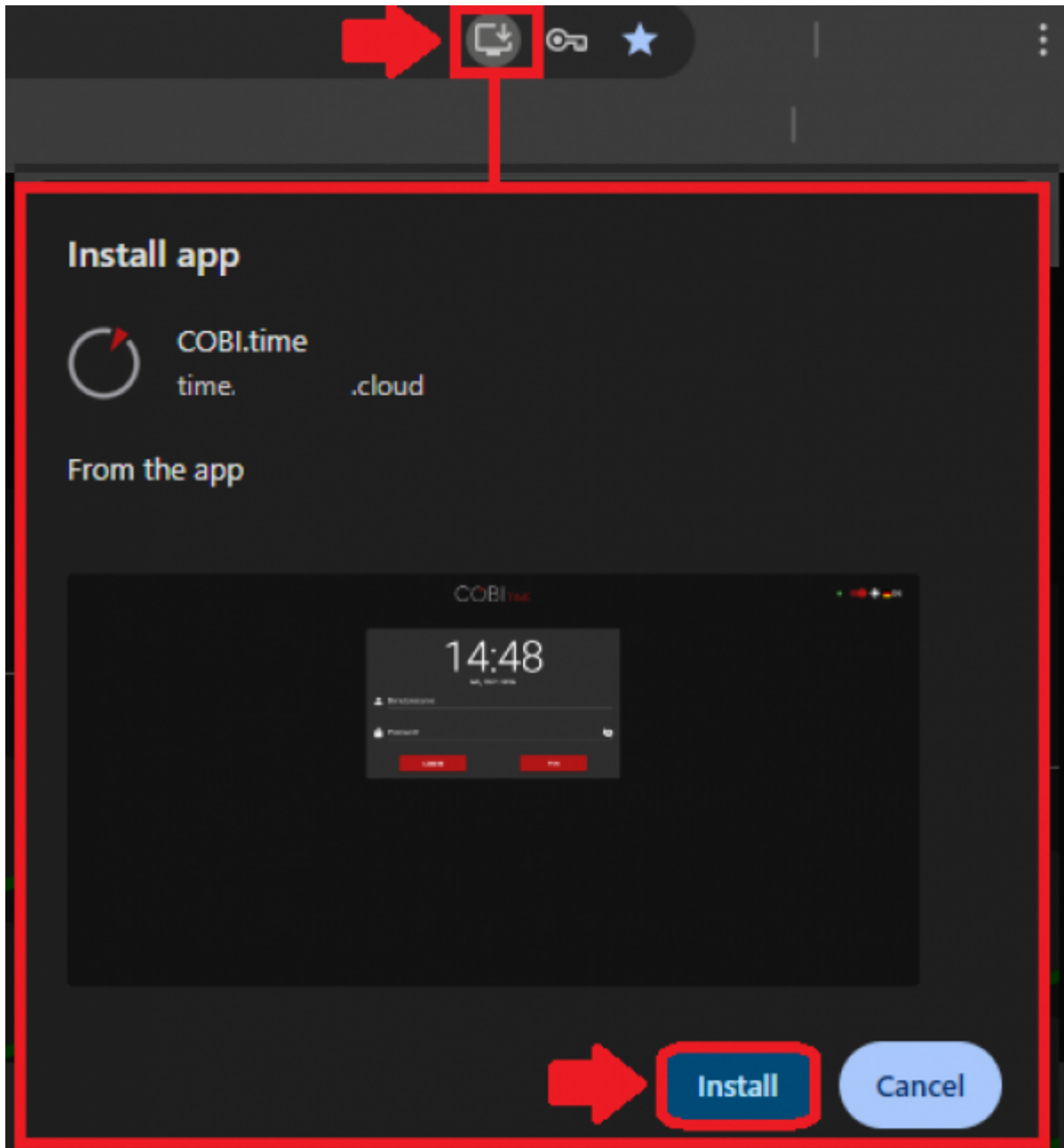

Instructions for Mozilla Firefox: Firefox does not natively support installation. However, you can add this functionality via an extension.

1. Open Settings / Extensions (`Ctrl + Shift + A`).
2. Search for the extension **“Progressive Web Apps for Firefox”**.
3. Install the extension and follow the setup instructions.
4. Once the extension is active, the icon to install COBI.time will also appear in the Firefox address bar.

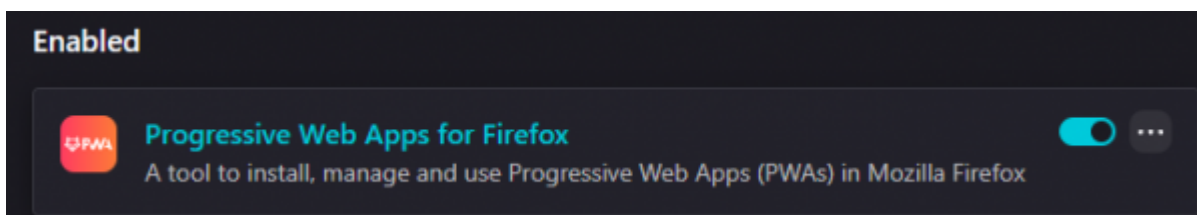

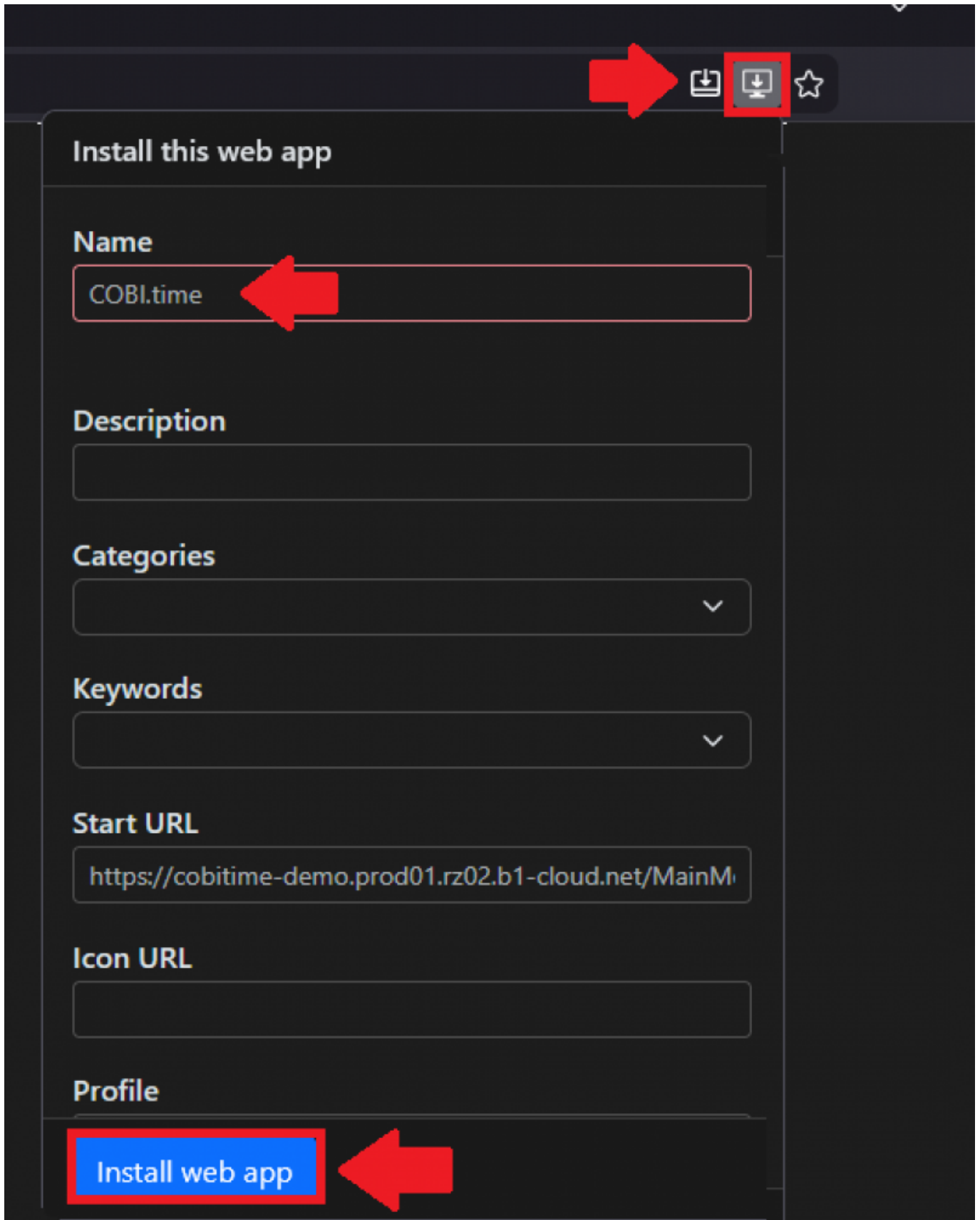

After installation, you will find COBI.time in your Start menu or on your desktop and can launch it like a normal program.

Installation (Android)

COBI.time can also be added as an app on Android (supported by Chrome and Firefox Android).

1. Open COBI.time in the browser on your smartphone.
2. Tap on the browser menu (the three dots or lines).
3. Select the option "Install app" or "Add to Home screen".

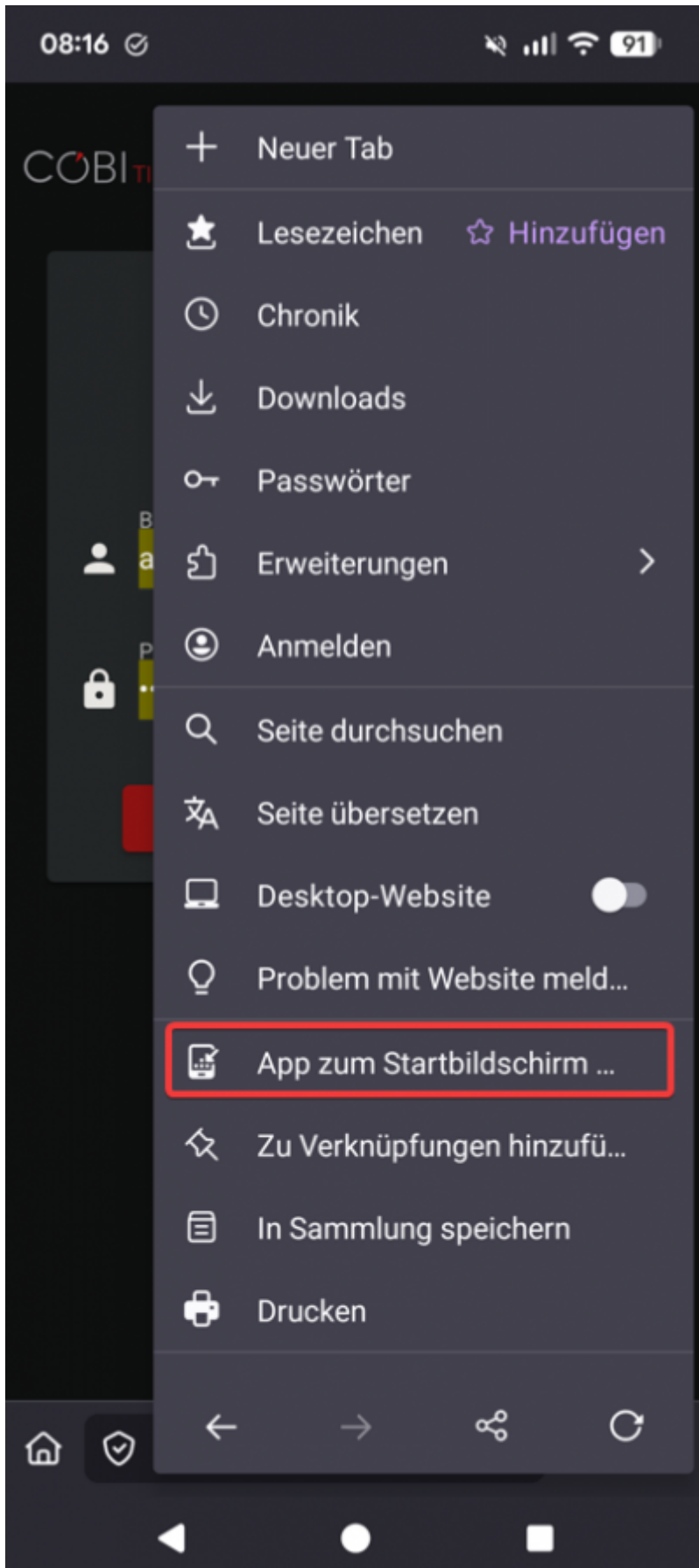

The COBI.time icon will now appear on your home screen.

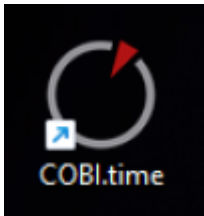

From:
<https://docs.cobisoft.de/wiki/> - **COBISOFT Documentation**

Permanent link:
https://docs.cobisoft.de/wiki/cobi.time/progressive_web_app?rev=1770809784

Last update: **2026/02/11 12:36**

